

## Shifting destinations

Zoé Cornelius, Théa Giglio, Claudia Gutiérrez Marfull



16.03.2023 - 06.04.2023

13 Vitrine, L-Espace du Fond  
Avenue de Morges 33, 1004 Lausanne

Perhaps what this is all about is a journey through time and space, undertaken by Zoé Cornelius, Théa Giglio and Claudia Gutiérrez Marfull and extended to us. But it is a complicated journey, with overlapping and intersecting narrative levels, and the destinations are never the ones originally planned. The artists are inviting us to reconsider the perception of temporality and territoriality and their intertwinings.

Time stand still

Time stood still

The process of identifying the different paths can be an autobiographical reading. They lead us to our own personal stories, by something old and new, memories for you and me, a collective consciousness.

The sound of water emanating from the circular fountain opens up a sonic dimension, seducing the hearing and creating an irregular loop, sometimes broken by a few bigger drops. The water is spouting from a naked woman, allowing a tree to root and a mammal to rest by her side.

The old swing swung by the wind. A patina is partially covering the red rubber where oneself used to sit. Its function is double as a sculptural and inanimate object hung in space and as an invitation to interact with it and with one another. The swing embodies the memory as a found altered object that recalls our past and reactivated by both human intervention and the air.

In the corner of the room, the sketch of a construction is echoing haphazardous architecture. These are ruins that draw new horizons. Fragments allow the possibility to (re)build with the debris, on top of a former infrastructure. A constant renewal.

On the opposite wall, the elaboration process of the tapestry is inscribed in the duration and induces a succession of events of which we know only the consequences. Colorful graffiti under a bright blue sky. The soil is bad, as the grass grows here and there. The image sewn on the canvas is shrunken by the tightness of the stitches and evokes a latent violence. A land that has been forgotten and neglected becomes the theater for new narratives.

Natural light is struggling to reach this room at the bottom of the studio space. Framed, the blank page which was meant to be used as a printing surface did not fulfill its initial purpose. The sheets become an object in itself. They have been folded, then forgotten and bleached, found and unfold. They are carrying the traces of time through shades of yellows, questioning their status and purpose.

Folded, forgotten and bleached

Found, unfold and framed

Time stood still



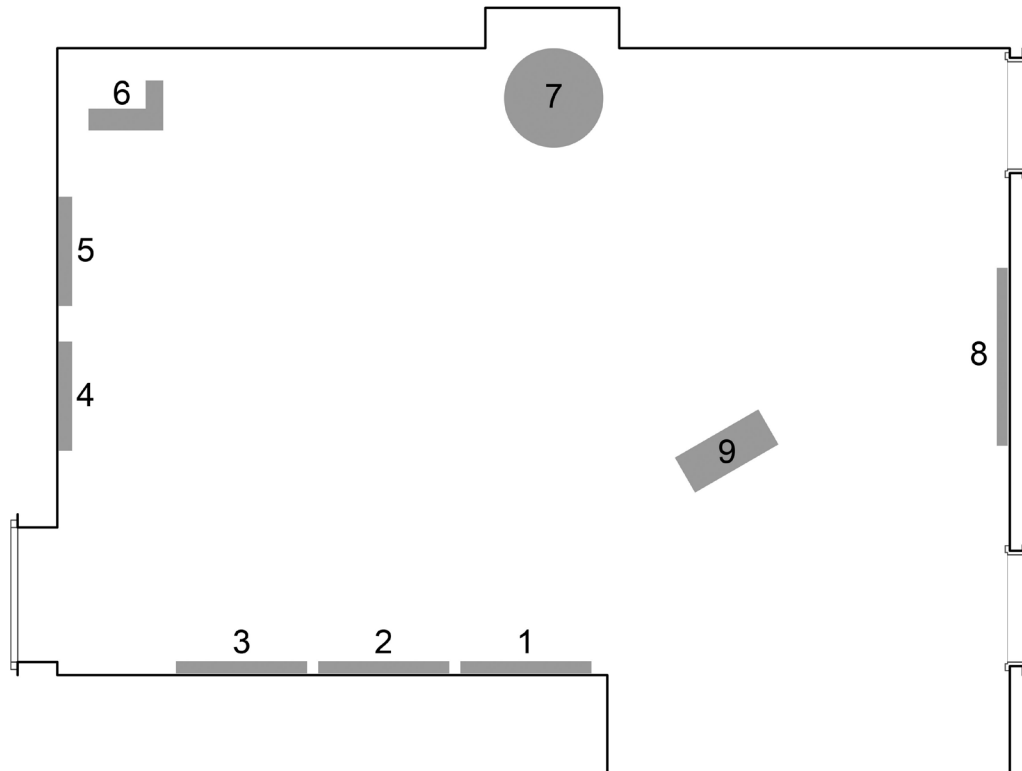

1. *Rubbles I*, Claudia Gutiérrez Marfull, embroidery, canvas fabric and acrylic wool
2. *Rubbles II*, Claudia Gutiérrez Marfull, embroidery, canvas fabric and acrylic wool
3. *Rubbles III*, Claudia Gutiérrez Marfull, embroidery, canvas fabric and acrylic wool
4. *Untitled (A Thousand Words) I*, Théa Giglio, 2023, unfolded paper, white wooden frame, UV glass
5. *Untitled (A Thousand Words) II*, Théa Giglio, 2023, unfolded paper, white wooden frame, UV glass
6. *Seven Bricks*, Théa Giglio, found bricks
7. *Andromède*, Zoé Cornelius, 2017-2023, mixed media
8. *Poco se gana hilando, pero menos mirando* (Little is gained by spinning, but less by looking), Claudia Gutiérrez Marfull, 2016, embroidery, aida fabric and acrylic wool
9. *Printemps*, Zoé Cornelius, 2023, steel chain, rubber